

徐工徐工 助您成功
XCMG FOR YOUR SUCCESS



XE35U 液压挖掘机

hydraulic excavator



地 址: 徐州经济技术开发区高新路39号
邮 编: 221004
客服电话: 400-110-9999
Add: Address: No.39 Gaoxin Road Economy Technology
Development Zone Xuzhou
Postal Code: 221004
Hot line: 400-110-9999



欢迎访问徐工商城
省心更省钱一站式



欢迎关注徐工工程机械官方微信:
1. 直接扫码“XCMG-999”添加好友。
2. 查找公众账号“XCMG徐工机械”。
3. 直接扫描上方二维码。

更节能环保

More energy-conservation and environmental protection

动力系统

采用洋马发动机，满足国三排放标准，机械式喷油泵性能更可靠，低速扭矩储备充足，动力强劲。

Power system

Yanmar engine is compliant with National III emission standard, the mechanical oil-injection pump has more reliable performance, sufficient reserve of low speed torque and strong power.

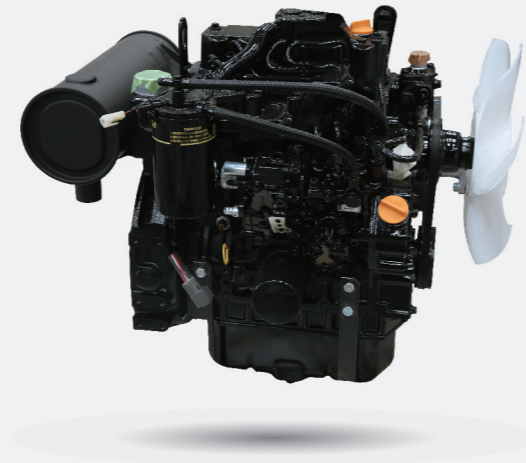

液压系统

- 关键液压件采用最新技术成果，能耗低，响应速度快，控制精准，冲击小，能保持强大的挖掘能力和优异的作业效率。发动机和液压系统功率完美匹配，保证发动机在最佳油耗区工作，提高燃油利用率，节约使用成本。

Hydraulic system

Key hydraulic components adopt up-to-date technological achievements, which have features of low energy consumption, fast response speed, accurate control and small impact so that strong digging force and excellent operating efficiency are ensured. The power of engine and hydraulic system match perfectly so that the engine can work in optimum fuel consumption region to improve fuel efficiency and save use cost.



更高效回报

More efficient return

- 采用无尾式设计，保证狭窄工况作业。工作装置左右偏转角度为75°、50°，可与上车回转实现复合操作，通过与上车的回转配合，可在狭小的空间内实现平行于墙面的挖掘，轻松应对各种工况。

The adoption of no-tail design ensures the machine work in narrow work conditions, the left and right angle of deflection of the working device is respectively 75 ° and 50 °, it can realize complex operation together with superstructure slewing to realize the digging operation parallel with wall surface in narrow and small space through the cooperation of superstructure slewing so as to easily deal with various operating conditions.

- 新型彩色大屏液晶监控器，符合人机工程学要求，自动控制功能更多，有效缩短故障排除时间。

New color LCD monitor compliant with ergonomics requirements has more automatic control functions so that trouble removing time is effectively shortened.



更可靠耐用

More reliable and durable

- 驾驶室配备大面积高强度钢化玻璃，保证强度的同时提升视野，驾驶室顶部配备照明灯，保证夜间工作精准安全。

Large area of tempered glasses with high strength are equipped on the cab, which ensures the strength meanwhile improves vision, floodlight is equipped on the roof of the cab to ensure accurate and safe operation at night.



- 强化动臂、斗杆，调整结构，分散应力，大大提高使用寿命。

Strengthened boom and arm, adjusted structure and dispersive stress greatly improve service life.



- 标配新型铲斗，铲斗深度减小，让卸料更快捷高效。

New type bucket with decreased depth is standard configuration, which makes unloading convenient and efficient.



- 采用X架底盘结构，加强筋板，扩大箱体截面，承载性能大大提升。

With X-frame chassis structure, reinforcing plate and enlarged box cross section, its bearing performance is greatly improved.

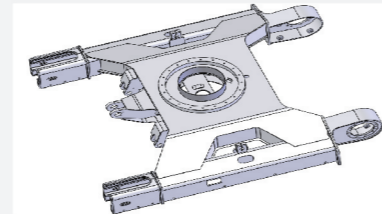

更舒适安全 More comfortable and safe

- 配备超大空间驾驶室，同级别中位于前列，冷暖空调、文件袋、安全带、杯托及备用电源等，极大提高舒适性和便捷性。

The cab with super large space is leading among the products of the same level, the air conditioner, file pockets, seat belts, cup holders and reserve power supply greatly enhance comfort and convenience.

- 通过先进焊接技术将驾驶室、底板、操纵台连成整体，大幅降低室内噪音，保证驾驶员的舒适性。

The cab, base plate and console are integrated by advanced welding technology, which greatly reduces indoor noise and ensures the comfort of driver.



便捷的维护保养 Convenient repair and maintenance

- 驾驶室可往前方翻转35°，发动机及其附件、主阀、回转马达、中心回转体方便检修。

The cab can be tilted forward for 35°, the engine and its accessories, main valve, slewing motor and central rotary joint are easy to be maintained.

- 驾驶室翻转后，配合全开式后机罩，发电机、启动马达、消声器、电气及液压系统可以快速维修，整机维修360°无死角。

After the cab is tilted, the generator, starting motor, muffler, electric and hydraulic systems can be maintained rapidly cooperated with fully-opened rear hood, there is no dead end within 360 degrees for maintenance of whole machine.



- 右侧机罩打开，空调滤清器、冷却液加注口、副水箱、电源总开关、空调干燥瓶、电瓶等维护便捷，省时省力。

When the right hood is opened, the air conditioner filter, coolant filling port, auxiliary water tank, power master switch, air conditioner dryer and battery can be maintained conveniently, which saves both time and labour.



定制化 Customization

标准配置 Standard configuration XE35U

| 发动机 Engine | 驾驶室与内饰 Cab and interior trim | 安全与保安配置 Safety and security configuration |
|--|--|--|
| 发动机型号 Engine model : 3TNV88 | 带数字显示的AM-FM收音机 AM - FM radio with digital display | 驾驶门锁和各舱室锁 Driving door locks and cabin locks |
| 排放等级 Emission level : 国三National III | 全天候隔音钢结构驾驶室 All - weather soundproof steel structure cab | 警报喇叭 Alarm horn |
| 手动预热 Manual preheating | 两个立体声扬声器 Two stereo speakers | 行走停车制动器 Parking brake for walking |
| 空气滤清器 (配备空气滤清器堵塞指示器) | 发动机钥匙开关 Engine key switch | 回转停车制动器 Rotary parking brake |
| Air cleaner (equipped with air cleaner blockage indicator) | 逃生锤 Emergency hammer | 蓄电池断路器 Battery circuit breaker |
| 空气滤清器双滤芯 Double filter element of air filter | 灭火器支架 Fire extinguisher support | 液压安全锁定杆 Hydraulic safety locking lever |
| 集筒式发动机油滤清器 Collector type engine oil filter | 前窗洗涤剂 Front window washer | 紧急逃生锤 Emergency escape hammer |
| 集筒式燃油主滤清器 Collector type fuel main filter | 可清洗地板垫 Cleanable floor mat | 左右后视镜 Left and right rearview mirrors |
| 散热器副水箱 Radiator auxiliary water tank | 搁脚板 Footrest board | 前工作灯 Front work light |
| 油水分离器 Oil-water separator | 豪华座椅 Luxury seat | 配重反射器 Counterweight reflector |
| 交流发电机 Alternator | 可开启的前上方挡风玻璃 Openable front upper windshield | 落物防护结构 (FOPS) Falling object protection structure (FOPS) |
| 软轴转速控制 Soft shaft speed control | 可拆除的前下方挡风玻璃 Removable front and lower windshield | |

| 液压系统 Hydraulic system | 电气系统 Electrical system |
|--|--|
| 带主溢流阀的控制阀 Control valve with main overflow valve | 蓄电池 (1 × 75AH) Battery (1 × 75Ah) |
| 先导滤清器 Pilot filter | 12V电源接口 12V power interface |
| 吸油滤清器 Oil suction filter | 发动机冷却水温显示 Engine cooling water temperature display |
| 蓄能器 Accumulator | 燃油油位显示 Fuel level display |
| 斗杆流量再生 Arm flow regeneration | 发动机转速显示 Engine speed display |
| 液压油 ISO VG 46 Hydraulic oil ISO VG 46 | 工作小时计 Working hour meter |
| 备用阀片 Spare valve plate | 发动机机油压力、发动机过热报警 Engine oil pressure, engine overheat alarm |

| 底盘系统与护罩 Chassis system and shield | 照明灯 Lighting lamp |
|---|--|
| 履带张紧机构 Track tensioning mechanism | 左侧臂工作灯 Left boom working light |
| 底架牵引环 Bottom frame traction ring | 驾驶室安装的工作灯 Working light mounted in the cab |
| 300mm三筋履带板 300 mm three-rib track shoe | |
| 底盘底部封板 Bottom sealing plate of chassis | |
| 行走马达封板 Walking motor sealing plate | |
| 履带夹轨器 Track clamp | |
| 推土铲 Bulldozer shovel | |
| 托链轮和支重轮 Supporting chain wheel and supporting wheel | |

| 工作装置 Working device |
|---|
| 动臂 Boom |
| 斗杆 Bucket rod |
| 铲斗 0.12m³ (ISO满斗) Bucket 0.12m³ (ISO full bucket) |

选装配置 Optional configuration XE35U

| | | |
|--|---|------------------------------|
| 液压管路: 破碎锤 Hydraulic pipeline: breaking hammer | 滚翻保护结构 (ROPS) Roll over protection structure (ROPS) | 贝壳斗 Shell bucket |
| 液压油 ISO VG 32,68 Hydraulic oil ISO VG 32, 68 | 快速连接器 Quick connector | 抓管机 Pipe grabbing machine |
| 灭火器 Fire extinguisher | 破碎锤 Breaking hammer | 12V点烟器 12V cigarette lighter |
| 动臂、斗杆保持阀 Boom and arm retaining valve | 液压拇指钳 Hydraulic thumb pliers | |
| 动臂、斗杆管路防爆阀 Explosion-proof valve for boom and arm pipeline | 振动夯 Vibrating tamper | |
| 旋转报警灯 Rotary alarm lamp | 液压剪 Hydraulic shear | |
| | 高频破碎机 High frequency crusher | |

XE35U HYDRAULIC EXCAVATOR

XE35U液压挖掘机

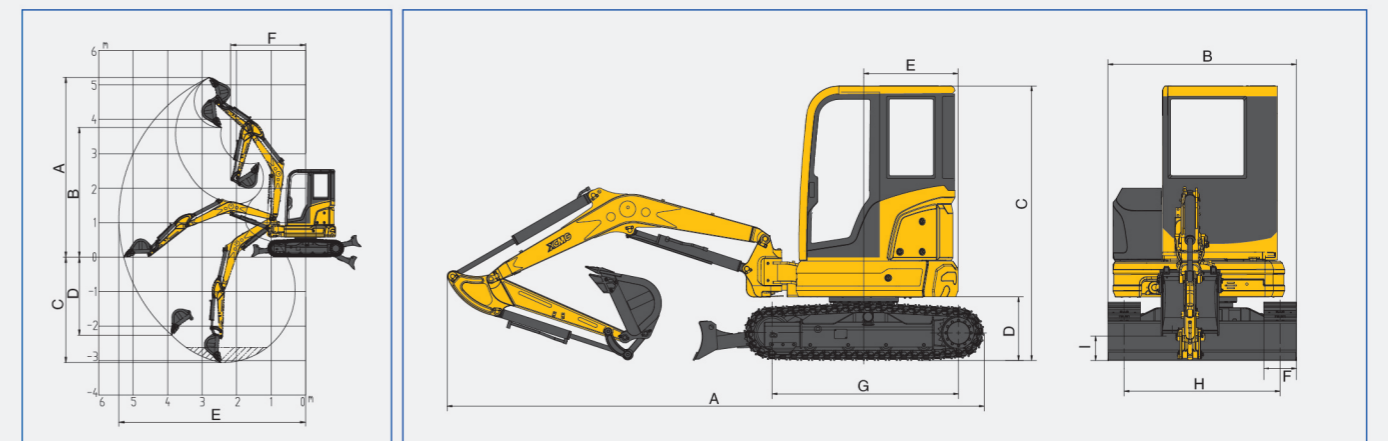

主要参数 / Main Specifications

| 型号 Model | 单位 UOM | 参数 Parameters |
|-----------------------|--------|---------------|
| 操作重量 Operating weight | Kg | 4200 |
| 铲斗容量 Bucket capacity | m³ | 0.12 |

| 发动机 Engine | | |
|------------------------------|---------|------------|
| 发动机型号 Engine Model | / | 3TNV88-B |
| 直喷 Direct Injection | / | √ |
| 4冲程 Four Strokes | / | √ |
| 水冷 Water Cooling | / | √ |
| 涡轮增压 Turbocharging | / | × |
| 缸数 No. of Cylinders | / | 3 |
| 发动机额定功率 Rated Power | kW/rpm | 22/2400 |
| 最大扭矩/转速 Maximum Torque/Speed | N.m/rpm | 106.4/1000 |
| 排量 Displacement | L | 1.642 |

| 主要性能 Main Performance | | |
|------------------------------|-------|---------|
| 行走速度 Travel Speed | km/h | 3.6/2.2 |
| 回转速度 Swing Speed | r/min | 8.5 |
| 爬坡能力 Gradeability | ° | 30 |
| 接地比压 Ground Pressure | kPa | 36.6 |
| 铲斗挖掘力 Bucket Digging Force | kN | 27.6 |
| 斗杆挖掘力 Arm Digging Force | kN | 20.4 |
| 最大牵引力 Maximum Tractive Force | kN | 31.6 |

| 液压系统 Hydraulic system | | |
|--------------------------------|-------|------|
| 主泵额定流量 Rated Flow of Main Pump | L/min | 102 |
| 工作压力 Working Pressure | MPa | 22 |
| 行走系统压力 Travel System Pressure | MPa | 21 |
| 回转系统压力 Swing System Pressure | MPa | 16.7 |
| 先导系统压力 Pilot System Pressure | MPa | 3.5 |

| 油类容量 Oil capacity | | |
|--------------------------------|---|----|
| 燃油箱容积 Fuel Tank Capacity | L | 40 |
| 液压油箱容积 Hydraulic Tank Capacity | L | 45 |
| 发动机机油容量 Engine Oil Capacity | L | 7 |

外形尺寸 Overall Dimensions

| 型号 Model | 单位 UOM | 参数 Parameters |
|--------------------------------------|--------|---------------|
| A 总长 Overall Length | mm | 4960 |
| B 总宽 Overall Width | mm | 1740 |
| C 总高 Overall Height | mm | 2550 |
| D 转台宽度 Width of Platform | mm | - |
| E 底盘总宽 Total Width of Chassis | mm | - |
| F 履带宽度 Track Shoe Width | mm | 300 |
| G 轮距 Length to Center of Rollers | mm | 1721 |
| H 轨距 Track Gauge | mm | 1440 |
| I 配重离地间隙 Counterweight Clearance | mm | 587 |
| J 最低离地间隙 Minimum Ground Clearance | mm | 297 |
| 推土铲 (宽/高) Dozer Blade (Width/Height) | mm | 1740 × 358 |

工作范围 Working Range

| | | |
|--|----|------|
| A 最大挖掘高度 Maximum Digging Height | mm | 5215 |
| B 最大卸载高度 Maximum Dumping Height | mm | 3760 |
| C 最大挖掘深度 Maximum Digging Depth | mm | 3060 |
| D 最大垂直挖掘深度 Maximum Vertical Wall Digging Depth | mm | 2260 |
| E 最大挖掘半径 Maximum Digging Radius | mm | 5415 |
| F 最小回转半径 Minimum Swing Radius | mm | 2170 |
| G 尾部最小回转半径 Minimum Tail Swing Radius | mm | 870 |
| 推土铲最大提升高度 Maximum Dozer Lifting Height | mm | 305 |
| 推土铲最大掘地深度 Maximum Dozer Cutting Depth | mm | 360 |

标配 Standard

| | | |
|---------------------|----|------|
| 动臂长度 Length of Boom | mm | 2560 |
| 斗杆长度 Length of Arm | mm | 1350 |
| 斗容 Bucket Capacity | m³ | 0.12 |

材料和规格可随时改变, 恕不另行通知
Materials and specifications may be changed at any time without prior notice